

M12

1200 ... 0...

Cordsets M12



Actuator/sensor cordset with overmolded connector

Cable end 1:

M12 female, straight, A-coded, IP67

Cable end 2:

blunt cut

Cable:

PVC, black

Approvals:



M12

1200 ... 0...

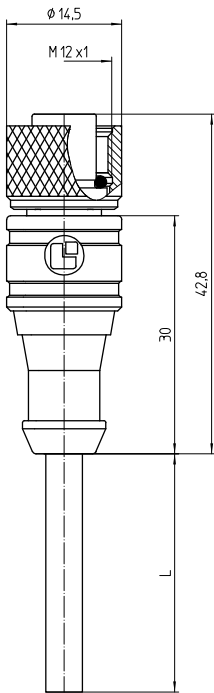

Pin assignments for female M12 connectors, A-coded, front view

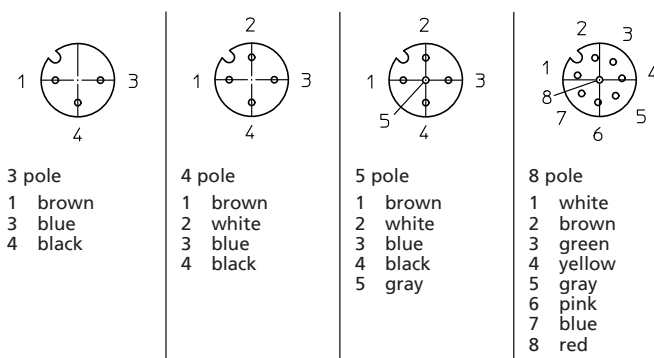

Environmental conditions

Temperature range -25 °C/+80 °C

Materials

Insulating body	TPU GF, HB according to UL94
Contact bush	CuZn, pre-nickel and gold-plated
Overmolding/handle	PVC, HB according to UL94
Knurled nut	CuZn, nickel-plated
Seal	FKM

Mechanical data

Mating cycles	≥ 100
Insertion force	≤ 10 N ¹
Withdrawal force	≤ 15 N ¹
Protection class	IP67 ²

¹ measured with a proper counterpart

² according to IEC DIN EN 60529, only in locked condition with an appropriate counterpart

Connected cable

Outer jacket PVC, black

Electrical data (at T_{amb} 20 °C)

Contact resistance	≤ 10 mΩ
Rated current	4 A (3–5 poles) 2 A (8 poles) 1.5 A (12 poles) (T _{amb} 40 °C)
Rated voltage	250 V AC/DC (3–4 poles) 60 V AC/DC (5 poles) 30 V AC/DC (8–12 poles)
Rated impulse voltage	2500 V (3–4 poles) 1500 V (5 poles) 800 V (8–12 poles)
Material group	I (IEC)/0 (UL) (CTI = 600)
Insulation resistance	> 100 MΩ

Associated products

Counterparts

☞ 1210 ... 0...	☞ 1210 ... 3...	☞ 1210 0800 ... 3...
☞ 1210 0806 ... L1 3...	☞ 1210 1200 ... 0...	☞ 1210 1200 ... 3...
☞ 1210 1205 ... 3...	☞ 1210 1206 ... L1 0...	☞ 1210 1206 ... L1 3...
☞ 1210 1206 ... L2 0...	☞ 1210 1206 ... L2 3...	☞ 1230 ... T16CW ...
☞ 1230 ... T16CW100 ...	☞ 1230 ... T16CW101 ...	☞ 1230 ... T16CW102 ...

M12

1200 ... 0...

-
- [🔗 1230 ... T16CW103 ...](#)
 - [🔗 1230 ... T16CW104 ...](#)
 - [🔗 1230 ... T16CW105 ...](#)
 - [🔗 1231 ... T16CW100 ...](#)
 - [🔗 1231 ... T9CP](#)
 - [🔗 1239 ... TOCB](#)
 - [🔗 1250 ... T...CR](#)
 - [🔗 1255 ... T9CR](#)

Accessories

- [🔗 9912 CPF0](#)
 - [🔗 9912 MRBU](#)
 - [🔗 9912 MRGN](#)
 - [🔗 9912 MRRD](#)
 - [🔗 9912 MRWH](#)
 - [🔗 9912 MRYE](#)
-

M12

1200 ... 0...

Designation	Pole Number	Connected Cable	PU (Pieces)	MDQ (Pieces)	Dimensions L (mm)
1200 03 001 1m	3	PVC, black, 3 x 0.34 mm ² (AWG 22), 910001, UL-style 2464	5	10	1000
1200 03 001 2m	3	PVC, black, 3 x 0.34 mm ² (AWG 22), 910001, UL-style 2464	5	10	2000
1200 04 002 2m	4	PVC, black, 4 x 0.34 mm ² (AWG 22), 910002, UL-style 2464	5	10	2000
1200 04 006 2m	4	PVC, black, 4 x 0.25 mm ² (AWG 24), 910006, UL-style 2464	5	10	2000
1200 04 002 5m	4	PVC, black, 4 x 0.34 mm ² (AWG 22), 910002, UL-style 2464	1	10	5000
1200 04 002 10m	4	PVC, black, 4 x 0.34 mm ² (AWG 22), 910002, UL-style 2464	1	10	10000
1200 04 002 20m	4	PVC, black, 4 x 0.34 mm ² (AWG 22), 910002, UL-style 2464	1	10	20000
1200 04 002 25m	4	PVC, black, 4 x 0.34 mm ² (AWG 22), 910002, UL-style 2464	1	10	25000
1200 08 004 10m	8	PVC, black, 8 x 0.25 mm ² (AWG 24), 910004, UL-style 2464	1	10	10000

Packaging:
in a plastic bag